

SITE CODE: MZ	DATE OPENED: 21 July	SU N°: 17123	MARZUOLO ARCHAEOLOGICAL PROJECT <small>NAME</small>
	DATE CLOSED: 21 July		
	INITIAL: RGV	AREA N°: 17000	

FORMATION PROCESS: ANTHROPIC <input checked="" type="checkbox"/> NATURAL <input type="checkbox"/>	DEFINITION: FOUNDATION between 17002 and 17120
	SU TYPE: <input type="checkbox"/> DEPOSIT <input type="checkbox"/> CUT <input checked="" type="checkbox"/> STRUCTURAL
	DISTINGUISHED BY: <input type="checkbox"/> COLOR <input type="checkbox"/> COMPACTION <input type="checkbox"/> COMPOSITION

DEPOSIT:	STRUCTURAL:	DESCRIPTION:
<ol style="list-style-type: none"> 1. Colour 2. Compaction 3. Composition 4. Inclusions (freq/med/rare) 5. Dimensions/Shape 6. Clarity of Limits (clear/not clear) 7. Fill of 8. Method & Conditions 	<ol style="list-style-type: none"> 1. Type (wall, cistern, etc.) 2. Technique (pisé, ashlar, etc.) 3. # of Coursings 4. Bonding Material 5. Facing/Finish (plaster, etc.) 6. Orientation 7. Dimensions 8. Abuts/butted by 9. Related architectural features 	<ol style="list-style-type: none"> 1. unclear - wall? THRESHOLD? 2. N/A 3. ore 4. white mortar 5. N/A 6. E-W 7. 1.5m length, 33-38cm width, 7.8cm deep 8. Abuts 17002, butted by 17122 9. wall 17002
CUT:		
<ol style="list-style-type: none"> 1. Shape in Plan 2. Top - BOS 3. Base - BOS 4. Sides 5. Orientation 6. Dimensions 7. Fill N°s 		

INTERPRETATION/DISCUSSION:
 Removal of 17042 (bottom of collapse or disturbed occupation level?) revealed alignment of stores in white mortar sitting on top of chocolate 17114 and abutting wall 17002 to East. Foundation for a dividing wall? Threshold for entryway? Stores and tiles continue to south, which may be a surface or collapse assoc with this su.

MATRIX:

	17122	17050	17042	
	17123	This context		
	17114	17002		

STRATIGRAPHIC RELATIONSHIPS:	FILLS:
CUT:	BUTTED BY: 17122
CUT BY:	FILLED BY:
ABUTS: 1702	COVERS: 17114
	EQUAL TO:
	COVERED BY: 17050, 17042
	BINDS TO:

ENVIRONMENTAL SAMPLES: POLLEN SOIL CHARCOAL OTHER (specify): _____

N/A

SPECIAL FINDS N ^o s:	FINDS TYPE:	SLAG <input type="checkbox"/>	DAUB <input type="checkbox"/>
	NONE <input type="checkbox"/>	GLASS <input type="checkbox"/>	WRKD WOOD <input type="checkbox"/>
	POTTERY <input type="checkbox"/>	BONE <input type="checkbox"/>	WRKD STONE <input type="checkbox"/>
	BRICK/TILE <input type="checkbox"/>	LEATHER <input type="checkbox"/>	OTHER (specify):
	METAL <input type="checkbox"/>	MORTAR <input type="checkbox"/>	

PHOTO N ^o s	101-8176 101-8177	PHOTO MODEL N ^o s	
------------------------	----------------------	------------------------------	--

SKETCH OF PLAN INCLUDE: 1. North Arrow; 2. Dimensions; 3. Sample Locations (if relevant); 4. Levels; 5. Grid Pts (if relevant); 6. Rise/Drop in Surface Level; 7. Abutting Architecture/Adjacent or Relevant Nearby Features for Reference; 8. All SU N^os

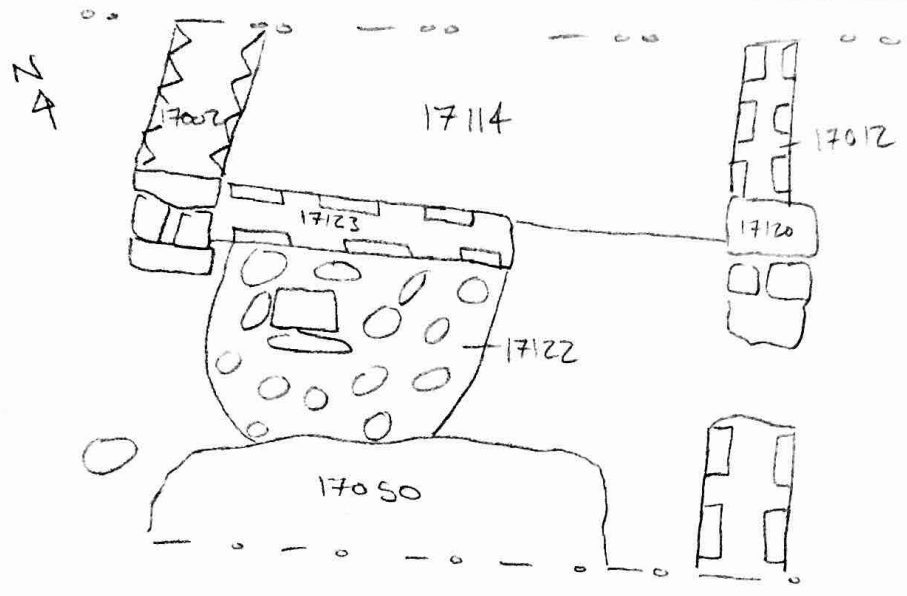

FIELD NOTEBOOK DRAWINGS - PAGE N ^o s		PROFILE DRAWING N ^o s	
STRATIGRAPHIC RELIABILITY	LOW	HIGH	APROX. DATE OF LAYER
	1 2 3 4 5	1 2 3 4 5	
CONFIDENCE IN INTERPRETATION	1 2 3 4 5	DATEABLE MATERIALS	
CONTAMINATION RISK	1 2 3 4 5		

COMMENTS/OBSERVATIONS:

ENTERED INTO DATABASE	INITIALS: KG	DATE: 23 July 2017
-----------------------	--------------	--------------------